

- NOTES:**
- WHEN INSTALLING PROPOSED WASTEWATER SEWERS ON LEILA AVE TAKE CAUTION WHEN CROSSING EXISTING RESIDENTIAL WATER SERVICES.
 - CONTRACTOR SHALL VERIFY ELEVATION OF EXISTING SEWER SERVICES AT PROPOSED DOWNSTREAM CONNECTION LOCATIONS PRIOR TO INSTALLATION OF COLLECTOR WWS TO ALLOW FOR CHANGES OF GRADE TO THE COLLECTOR WWS.

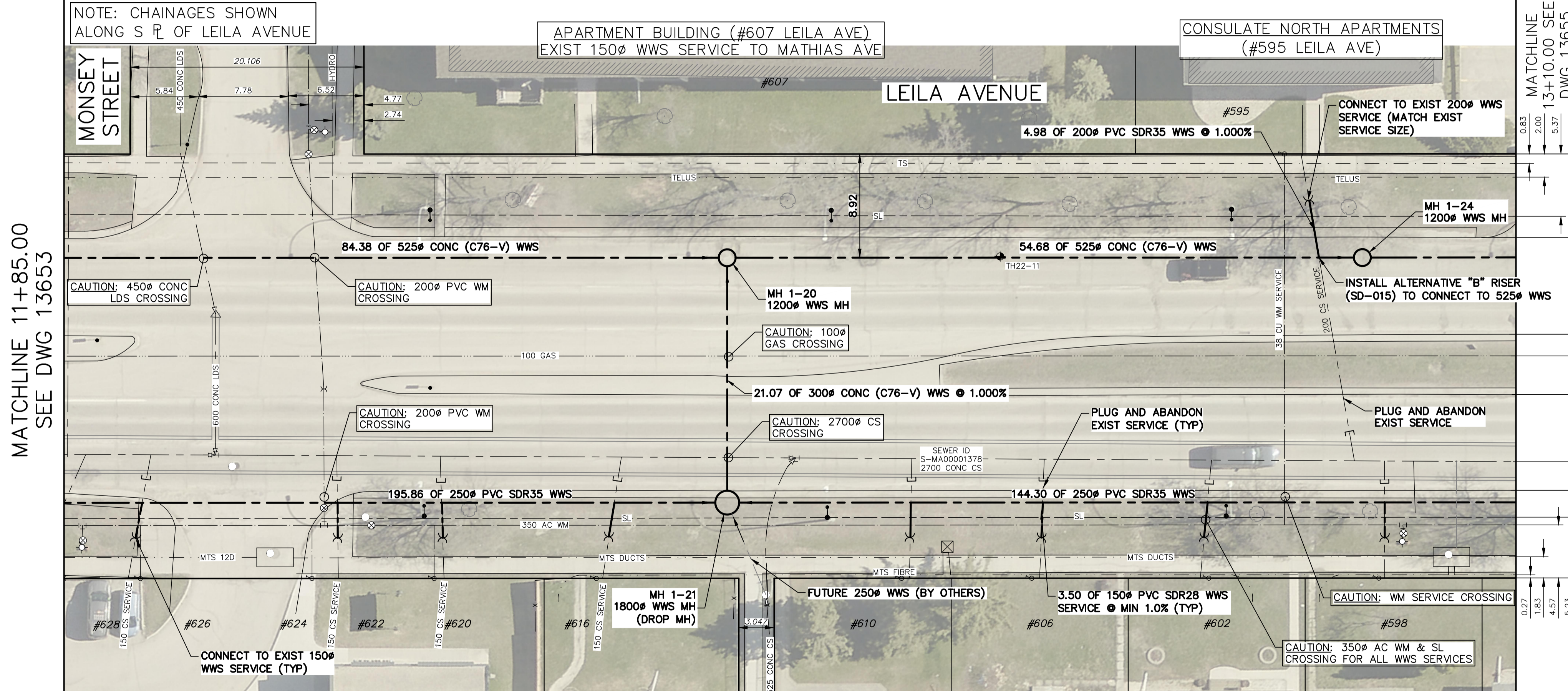

SEWER SERVICE INFORMATION						
ADDRESS	STATUS	SIZE (mm) MATERIAL	COORDINATES AT JUNCTION	COORDINATES AT PROPERTY	REMARKS	
#598 LEILA AVE	UNKNOWN	150 UNKNOWN	N=5534572.74 E=633981.66	UNKNOWN	NONE	
#598 LEILA AVE	ACTIVE	150 UNKNOWN	N=5534573.82 E=633979.40	N=5534564.69 E=633975.14	NONE	
#595 LEILA AVE	ACTIVE	200 UNKNOWN	N=5534574.93 E=633977.05	N=5534600.79 E=633984.09	NONE	
#602 LEILA AVE	ACTIVE	150 UNKNOWN	N=5534580.21 E=633985.94	N=5534571.42 E=633980.76	NONE	
#606 LEILA AVE	ACTIVE	150 UNKNOWN	N=5534586.39 E=633952.93	N=5534577.28 E=633948.23	NONE	
#610 LEILA AVE	ACTIVE	150 UNKNOWN	N=5534591.28 E=633942.63	N=5534582.11 E=633938.08	NONE	
#616 LEILA AVE	ACTIVE	150 UNKNOWN	N=5534602.00 E=633920.05	N=5534593.23 E=633914.16	NONE	
#620/622 LEILA AVE	ACTIVE	150 UNKNOWN	N=5534608.69 E=633905.96	N=5534599.02 E=633901.79	NONE	
#624/626 LEILA AVE	ACTIVE	150 UNKNOWN	N=5534612.50 E=633897.92	N=5534602.88 E=633893.55	NONE	
#628 LEILA AVE	ACTIVE	150 UNKNOWN	N=5534619.35 E=633893.44	N=5534610.55 E=633877.17	NONE	
#630 LEILA AVE	ACTIVE	150 UNKNOWN	N=5534621.72 E=633878.34	UNKNOWN	NONE	
#640 MATHIAS AVE	ACTIVE	250 UNKNOWN	N=5534622.42 E=633876.97	UNKNOWN	NONE	

SEWER JUNCTION INFORMATION FROM SEWER VIDEO INSPECTION			
SEWER ID S-MA00002050			
DISTANCE FROM MH ID S-MH00001804	DIAMETER	CLOCK	
153.4	250	11	
155.0	150	1	
160.8	150	2	
165.4	450	9	

SEWER JUNCTION INFORMATION FROM SEWER VIDEO INSPECTION			
SEWER ID S-MA00001787			
DISTANCE FROM MH ID S-MH00001787	DIAMETER	CLOCK	
6.8	150	2	
15.7	150	2	
31.3	150	2	
46.3	525	3	
56.3	150	2	
67.7	150	2	
82.1	150	2	
94.4	200	10	
97.3	150	2	
99.5	150	2	
103.2	150	2	



FOR INDEX PAGE SEE DWG 13643

METRIC
WHOLE NUMBERS INDICATE MILLIMETRES
DECIMALIZED NUMBERS INDICATE METRES

SCALE 1:250 (A1)

WARNING

IF POWER EQUIPMENT OR EXPLOSIVES ARE TO BE USED FOR EXCAVATION ON THIS PROJECT THE CONTRACTOR MUST:

- NOTIFY THE GAS COMPANY OF THE PROPOSED LOCATION OF EXCAVATION.
- TAKE PRECAUTION TO AVOID DAMAGE TO GAS COMPANY INSTALLATIONS.

SEE PROVINCIAL REGULATION 210/72 FOR DETAILS

LOCATION APPROVED UNDERGROUND STRUCTURES

SUPV. U/G STRUCTURES COMMITTEE DATE

NOTE:
LOCATION OF UNDERGROUND STRUCTURES AS SHOWN ARE BASED ON THE BEST INFORMATION AVAILABLE BUT NO GUARANTEE IS GIVEN THAT ALL EXISTING UTILITIES ARE SHOWN OR THAT THE GIVEN LOCATIONS ARE EXACT. CONFIRMATION OF EXISTENCE AND EXACT LOCATION OF ALL SERVICES MUST BE OBTAINED FROM THE INDIVIDUAL UTILITIES BEFORE PROCEEDING WITH CONSTRUCTION.

VERTICAL DATUM: CGVD28 (HT2.0 Geoid)
HORIZONTAL DATUM: NAD83 (June 1990), Zone 14

NO.	ISSUED FOR CONSTRUCTION	DATE (YYYY/MM/DD)	MID	BY
0	ISSUED FOR CONSTRUCTION	2026/03/10		

KGS GROUP

DESIGNED BY	MID	CHECKED BY	TLE
DRAWN BY	GEL	APPROVED BY	RBO
SCALE:		RELEASED FOR CONSTRUCTION	
HORIZONTAL	1:250	DUANE BAKER	
VERTICAL	1:50	DATE	2026/03/12

PLOT DATE:

ENGINEER'S SEAL

ORIGINAL DRAWING SEALED BY:
M.A. IANKOVA-DEDOVA
2026/03/11

CONSULTANT DRAWING NUMBER
C1-13

THE CITY OF WINNIPEG
WATER AND WASTE DEPARTMENT
ENGINEERING SERVICES DIVISION

ARMSTRONG SEWER RELIEF WORKS
CONTRACT 1
LEILA AVENUE
5.7 W OF MONSEY STREET TO
81.5 W OF DIPLOMAT DRIVE

SHEET 13 OF 46
CITY DRAWING NUMBER
13654